

62 CHELMSFORD AVENUE, NSW 2192

LANDSCAPE DA DOCUMENTATION

DRAWING REGISTER

DRAWING NUMBER	DRAWING NAME	SCALE / SIZE	REVISION
LA-00	COVER SHEET	-	A
LA-01	LANDSCAPE PLAN	1:200 @ A3	A
LA-02	LANDSCAPE DETAILS	-	A

INDICATIVE PLANT SCHEDULE

BOTANICAL NAME	COMMON NAME	MATURE HEIGHT	NATIVE	INSTALL SIZE	SPACING	QUANTITY
TREES						
TRISTANIOPSIS 'LUSCIOUS'	WATERGUM	8-10M	√	100L BAG	AS SHOWN	1
SHRUBS						
GARDENIA 'O SO FINE'	GARDENIA	0.3M		200MM POT	3 / M ²	-
PLECTRANTHUS ARGENTUS	SILVER PLECTRANTHUS	0.5M		200MM POT	2 / M ²	-
RHAPHIOLEPIS 'COSMIC WHITE'	INDIAN HAWTHORN	1.5-2M		200MM POT	3 / M ²	-
VIBURNUM 'DENSE FENCE'	VIBURNUM	2.5M		200MM POT	800MM	-
WESTRINGIA 'GREY BOX'	COASTAL ROSEMARY	0.3-0.4M	√	200MM POT	2 / M ²	-
WESTRINGIA 'NARINGA'	NARINGA COASTAL ROSEMARY	1-2.5M	√	200MM POT	3 / M ²	-
GROUNDCOVERS & GRASSES						
DIANELLA 'BREEZE'	DIANELLA	0.6-0.7M	√	140MM POT	6 / M ²	-
DICHONDRA REPENS	KIDNEY WEED	0.1M	√	140MM POT	6 / M ²	-
DIETES GRANDIFLORA 'GRAND STAR'	DIETES	0.6-0.7M	√	140MM POT	6 / M ²	-
LIRIOPE 'JUST RIGHT'	LIRIOPE	0.5M		140MM POT	6 / M ²	-
MYOPORUM 'YAREENA'	MYOPORUM	0.1M	√	140MM POT	3/ M ²	-
PHILODENDRON 'LITTLE PHIL'	PHILODENDRON	0.35M		140MM POT	6 / M ²	-
TRACHELOSPERMUM 'FLAT MAT'	STAR JASMINE	0.3-0.4M		140MM POT	3/ M ²	-

<div>LANDSCAPE ARCHITECT</div> <div>GROUND INK</div> <div>SUITE 201, 75 ARCHER ST, CHATSWOOD NSW 2067 PH. (02) 9411 3279 WWW.GROUNDINK.COM.AU</div> <div>© GROUND INK PTY LTD THIS DESIGN AND DRAWING IS PROTECTED BY COPYRIGHT.</div>	<div>NOTE</div> <div>VERIFY ALL DIMENSIONS ON SITE BEFORE COMMENCING WORK. REPORT ALL DISCREPANCIES TO LANDSCAPE ARCHITECT PRIOR TO CONSTRUCTION. FIGURED DIMENSIONS TO BE TAKEN IN PREFERENCE TO SCALED DRAWINGS. ALL WORK IS TO CONFORM TO RELEVANT AUSTRALIAN STANDARDS AND OTHER CODES AS APPLICABLE. LOCATION OF UNDERGROUND SERVICES TO BE PROVEN ON SITE AND PROTECTED IF NECESSARY PRIOR TO CONSTRUCTION. DIAL BEFORE YOU DIG. PLANT SPECIES AND QUANTITIES SHOWN ARE INDICATIVE ONLY AND ARE SUBJECT TO CHANGE BASED ON FUTURE PROJECT REQUIREMENTS.</div>	ISSUE	DATE	DESCRIPTION	DRAWN	REVIEW	DRAWING TITLE	DATE	JOB NUMBER	DRAWING NUMBER	
		A	29/04/24	DA ISSUE	RL/QN	RL		COVER SHEET	20-MAY-24	20240424	LA-00
		B	30/04/24	DA ISSUE	QN	RL			PROJECT 62 CHELMSFORD AVENUE BELMORE, NSW 2192		
		C	20/05/24	DA ISSUE	QN	RL					
											REV C

CHELMSFORD AVENUE

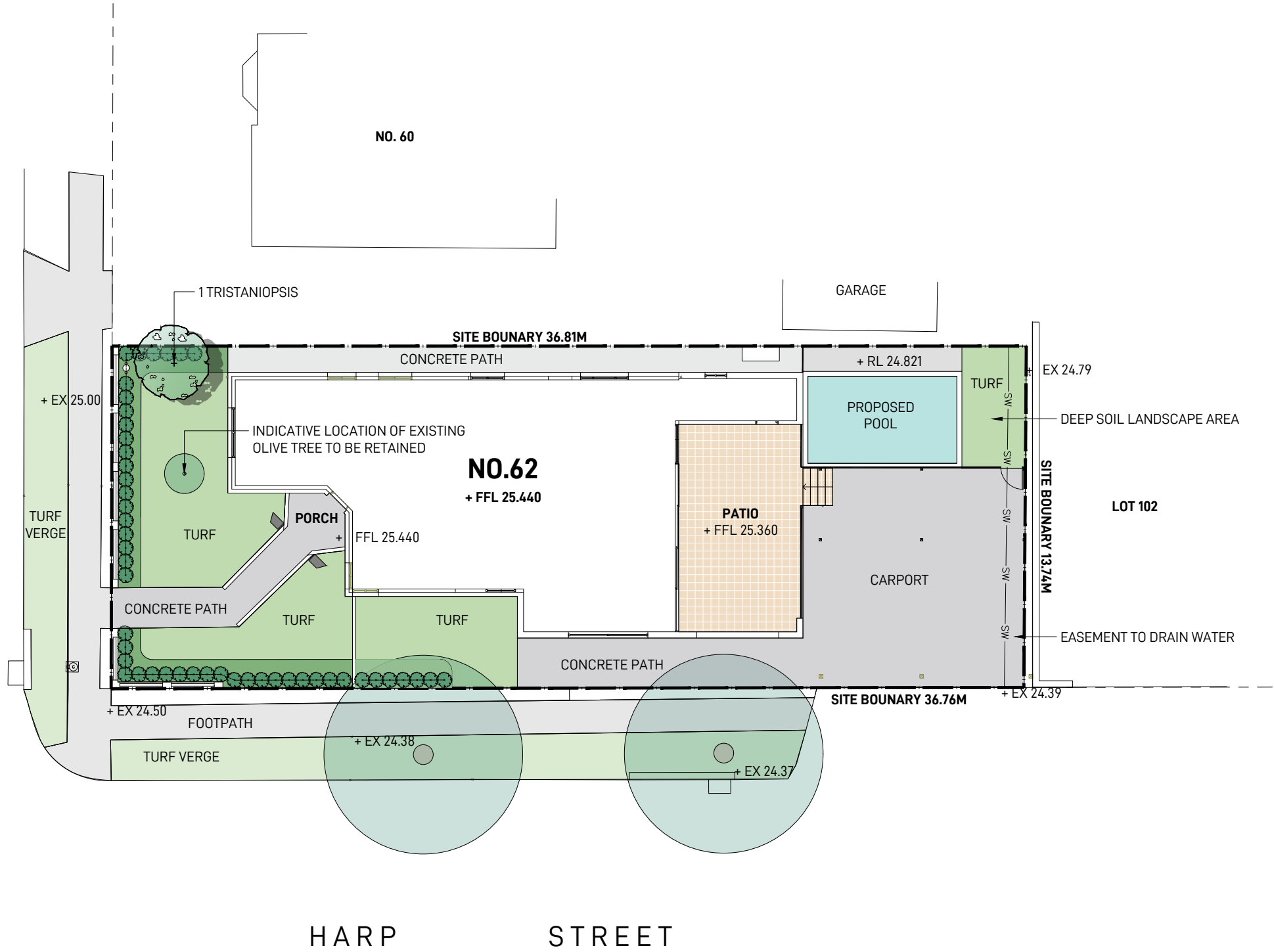

LEGEND

- SITE BOUNDARY
- APPROXIMATE LOCATION OF SEWER LINE
- FFL 39.00 FINISHED FLOOR LEVEL
- + EX 39.00 EXISTING SPOT LEVEL
- + RL 39.00 PROPOSED SPOT LEVEL
- GARDEN BED
- TURF
- EXISTING TREES TO BE RETAINED
- PROPOSED TREES

LANDSCAPE ARCHITECT
GROUND INK
SUITE 201, 75 ARCHER ST, CHATSWOOD NSW 2067
PH. (02) 9411 3279 | WWW.GROUNDINK.COM.AU
© GROUND INK PTY LTD THIS DESIGN AND
DRAWING IS PROTECTED BY COPYRIGHT.

NOTE
VERIFY ALL DIMENSIONS ON SITE BEFORE COMMENCING WORK. REPORT ALL DISCREPANCIES TO LANDSCAPE ARCHITECT PRIOR TO CONSTRUCTION. FIGURED DIMENSIONS TO BE TAKEN IN PREFERENCE TO SCALED DRAWINGS. ALL WORK IS TO CONFORM TO RELEVANT AUSTRALIAN STANDARDS AND OTHER CODES AS APPLICABLE. LOCATION OF UNDERGROUND SERVICES TO BE PROVEN ON SITE AND PROTECTED IF NECESSARY PRIOR TO CONSTRUCTION. DIAL BEFORE YOU DIG. PLANT SPECIES AND QUANTITIES SHOWN ARE INDICATIVE ONLY AND ARE SUBJECT TO CHANGE BASED ON FUTURE PROJECT REQUIREMENTS.

ISSUE	DATE	DESCRIPTION	DRAWN	REVIEW
A	29/04/24	DA ISSUE	RL/QN	RL
B	30/04/24	DA ISSUE	QN	RL
C	20/05/24	DA ISSUE	QN	RL

DRAWING TITLE
LANDSCAPE PLAN

DATE	JOB NUMBER	DRAWING NUMBER
20-MAY-24	20240424	LA-01
PROJECT 62 CHELMSFORD AVENUE BELMORE, NSW 2192		NORTH
SCALE 1:200 @ A3 0 1 2 3 4M		REV C

GENERAL SOLUTIONS V

THE MAINTENANCE SHALL MEAN THE CARE AND MAINTENANCE OF THE LANDSCAPE WORKS BY ACCEPTED HORTICULTURAL PRACTICE AS RECTIFYING ANY DEFECTS THAT BECOME APPARENT IN THE LANDSCAPE WORKS UNDER NORMAL USE. THE LANDSCAPE CONTRACTOR SHALL ATTEND THE SITE ON A WEEKLY BASIS TO MAINTAIN THE LANDSCAPE WORKS FOR THE FULL TERM APPROVED AT CC STAGE OF THE MAINTENANCE PERIOD (COMMENCING FROM PRACTICAL COMPLETION).

DURING THE TERM OF THE MAINTENANCE PERIOD THE LANDSCAPE CONTRACTOR SHALL UNDERTAKE RUBBISH REMOVAL FROM THE SITE ON A WEEKLY BASIS TO ENSURE THE SITE REMAINS IN TIDY CONDITION.

WEED GROWTH THAT MAY OCCUR IN, PLANTED OR MULCHED AREAS IS TO BE REMOVED USING ENVIRONMENTALLY ACCEPTABLE METHODS I.E. NON-RESIDUAL GLYPHOSATE HERBICIDE, (E.G. 'ROUNDUP', APPLIED IN ACCORDANCE WITH THE MANUFACTURER'S DIRECTIONS) OR HAND WEEDING.

TREES SHALL SHOW SIGNS OF HEALTHY VIGOROUS GROWTH AND BE FREE FROM DISEASE AND NOT EXHIBIT SIGNS OF STRESS PRIOR TO HANDOVER TO THE CLIENT. ANY TREES OR PLANT THAT DIE OR FAIL TO THRIVE, OR ARE DAMAGED OR STOLEN WILL BE REPLACED. REPLACEMENT MATERIAL SHALL HAVE THE MAINTENANCE PERIOD EXTENDED IN ACCORDANCE WITH THE LANDSCAPE CONTRACT CONDITIONS. TREES AND PLANT MATERIALS SHALL BE EQUAL TO THE MINIMUM REQUIREMENTS OF SPECIES SPECIFIED AND APPROVED MATERIAL DELIVERED TO SITE. SHOULD THE CONDITION DECLINE FROM THE APPROVED SAMPLE THE SUPERINTENDENT RESERVES THE RIGHT TO REJECT THE TREE / PLANTS.

FREQUENCY: AS REQUIRED.

SELECTIVE PRUNING MAY BE REQUIRED DURING THE ESTABLISHMENT PERIOD TO PROMOTE A BALANCED CANOPY STRUCTURE. THESE ACTIVITIES SHALL BE CARRIED OUT TO THE BEST HORTICULTURAL AND INDUSTRY PRACTICE. ALL PRUNED MATERIAL IS TO BE REMOVED FROM SITE.

A LOW VOLUME DRIP IRRIGATION SYSTEM MAY BE INSTALLED AT THE DISCRETION OF THE DEVELOPER. POSITION OF CONTROL BOX, SOLENOIDS AND IRRIGATION CONDUITS TO BE DESIGNED BY QUALIFIED IRRIGATION ENGINEER AT CC STAGE

CONTROLLERS SHALL BE MOUNTED ON A STABLE WALL, POWER RACK, OR FORMED AND CONSTRUCTED CONCRETE BASED PEDESTAL MOUNT.

PERFORMANCE SPECIFICATION TO BE PROVIDED BY LANDSCAPE ARCHITECT, NOMINALLY 25MM DELIVERED TO PLANT AREAS EACH WEEK DURING ESTABLISHMENT (DEPENDING ON WEATHER CONDITIONS). AFTER ESTABLISHMENT, IRRIGATION RATES CAN BE DECREASED IN CERTAIN AREAS OF THE LANDSCAPE DEPENDING ON THE SPECIES.

IMPLEMENT AN APPROPRIATE HAND WATERING REGIME IN AREAS NOT IRRIGATED IN ASSOCIATION WITH CURRENT WATERING PROGRAMME TO MAINTAIN PLANT HEALTH AND VIGOUR. THE PROGRAM SHALL REFLECT SEASONAL CONDITIONS AND PLANT SPECIES.
FREQUENCY: WEEKLY OR AS REQUIRED.

ALL LANDSCAPE AREAS ARE TO HAVE POSITIVE DRAINAGE TO SW SYSTEMS. IF AREAS OF POOR DRAINAGE ARE IDENTIFIED ON SITE THEN THIS SHOULD BE BROUGHT TO THE SITE SUPERINTENDENTS ATTENTION. INSTALL AGG LINES IF REQUIRED.

HORIZON A - GARDEN BEDS ON NATURAL GROUND
A SANDY LOAM TO CLAY LOAM TOPSOIL MIX DESIGNED FOR GENERAL PURPOSE, ON-GRADE LANDSCAPE GARDEN BED PLANTING OF GRASSES, WOODY AND HERBACEOUS ANNUALS AND PERENNIALS THAT HAVE HIGH NUTRIENT REQUIREMENT FOR SUSTAINED OPTIMUM GROWTH, AND ARE NOT SUBJECT TO COMPACTION BY PEDESTRIAN AND OTHER FOOT TRAFFIC. HEAVIER TEXTURED SOILS IN THIS SPECIFICATION MAY REQUIRE ENGINEERED

HORIZON B - LARGER POTTED PLANTING BELOW 300MM
A SANDY, WELL DRAINED MEDIUM WITH LOW ORGANIC MATTER FOR
BACKFILLING BELOW 300MM FROM THE SURFACE IN LARGER POTTED
SPECIMENS OVER 45L OR 400MM DEPTH OF ROOT BALL, SEMI-ADVANCED,
ADVANCED AND SUPER ADVANCED TREE PLANTING. THE SPECIFICATION MAY
USE A SMALL PROPORTION OF SITE WON TOPSOIL OR SUBSOIL, PROVIDED THE
ORGANIC MATTER UPPER LIMIT IS NOT EXCEEDED.

ALL GARDEN BEDS TO BE CULTIVATED TO A MIN DEPTH OF 150MM AND TREE PITS TO THE DEPTH OF THE ROOT BALL ONLY. IF ADDITIVES SUCH AS GYPSUM ARE REQUIRED CONDUCT THIS AFTER CULTIVATION INTO THE TOP 100MM OF SOIL.

ALL PLANTING TO BE GROWN TO NATSPEC SPECIFICATIONS. CONTRACTOR TO PREPARE SITE FOR PLANTING INCLUDING WATERING, HANDLING, SETTING OUT AND EXCAVATION. EXCAVATE A HOLE FOR EACH PLANT LARGE ENOUGH TO PROVIDE NOT LESS THAN 100MM ALL AROUND THE ROOT SYSTEM OF THE PLANT. FOR TREE PLANTING EACH HOLE SHALL BE DUG WITH A SHOVEL, BACKHOE OR SIMILAR TOOL. INDIVIDUAL HOLES SHALL BE EXCAVATED TO ALLOW ROOT SYSTEM TO SIT FLAT ON THE EXCAVATED HOLE AND 400MM TO EACH SIDE OF THE ROOT SYSTEM. BACKFILL PLANTING HOLES WITH EXISTING SITE SOIL AND TOPSOIL AS DESCRIBED IN SECTION 'SOIL'; PLANT / TREE SHALL BE SET PLUMB, WITH THE ROOT BALL SET SLIGHTLY BELOW THE FINAL SOIL LEVEL.

THE LANDSCAPE CONTRACTOR SHALL SUPPLY AND INSTALL 10MM PINE BARK MULCH TO ALL GARDEN BEDS SHOWN ON THE LANDSCAPE PLANS, TO A MINIMUM DEPTH OF 75MM. ALL MULCH IS TO BE FREE OF DELETERIOUS MATTER SUCH AS SOIL, WEEDS AND STICKS. MULCHED SURFACES ARE TO BE KEPT CLEAN AND TIDY AND FREE OF ANY DELETERIOUS MATERIAL AND FOREIGN MATTER. REINSTATE DEPTHS TO A UNIFORM LEVEL OF 75MM WITH MULCH AS SPECIFIED, MULCH TO BE FREE OF ANY WOOD MATERIAL IMPREGNATED WITH CCA OR SIMILAR TOXIC TREATMENT. MAINTAIN WATERING RINGS AROUND TREES. TOP UP MULCH LEVELS PRIOR TO HANDOVER TO CLIENT.

THE LANDSCAPE CONTRACTOR SHALL SUPPLY AND INSTALL SAPPHIRE BUFFALO TURF IN STRETCHER PATTERN TO ALL TURF AREAS SHOWN ON THE LANDSCAPE PLANS AND IS TO FINISH FLUSH WITH ADJACENT SURFACES. TURF TO BE A MIN THICKNESS OF 50MM WITH A 40MM MOWING HEIGHT. CONTRACTOR TO ALLOW FOR FERTILISING, LAYING, TAMPING, WATERING, TOP DRESSING, MAINTENANCE AND MOWING. THE LANDSCAPE CONTRACTOR SHALL SUPPLY AND INSTALL TURF UNDERLAY UNDER ALL TURF AREAS, CONSISTING OF 100MM THICK LAYER OF SCREENED TOP SOIL.

THE LANDSCAPE CONTRACTOR SHALL SPRAY FOR PESTS AND DISEASE INFESTATIONS WHEN THE PEST AND FUNGAL ATTACK HAS BEEN POSITIVELY IDENTIFIED AND WHEN THEIR POPULATIONS HAVE INCREASED TO A POINT THAT WILL BECOME DETRIMENTAL TO PLANT GROWTH. APPLY ALL PESTICIDES TO MANUFACTURER'S DIRECTIONS.
FREQUENCY: WEEKLY INSPECTION

PELLETS SHALL BE IN THE FORM INTENDED TO UNIFORMLY RELEASE PLANT FOOD ELEMENTS FOR A PERIOD OF APPROXIMATELY NINE MONTHS EQUAL TO SHIRLEYS KOKEI PELLETS, ANALYSIS 6.3.1:8.2.9 OR SIMILAR APPROVED. KOKEI PELLETS SHALL BE PLACED AT THE TIME OF PLANTING TO THE BASE OF THE PLANT, 50MM MINIMUM FROM THE ROOT BALL AT A RATE OF TWO PELLETS PER 300MM OF TOP GROWTH TO A MAXIMUM OF 8 PELLETS PER TREE. GENERALLY CHECK FOR SIGNS OF NUTRIENT DEFICIENCIES (YELLOWING OF LEAVES, FAILURE TO THRIVE), AND ADAPT FERTILISER REGIME TO SUIT. FERTILISER SHOULD BE APPLIED AT THE BEGINNING AND THE END OF THE (SUMMER) GROWING SEASON.

[illegible]

<div>LANDSCAPE ARCHITECT</div> <div>GROUND INK</div> <div>SUITE 201, 75 ARCHER ST, CHATSWOOD NSW 2067 PH. (02) 9411 3279 WWW.GROUNDINK.COM.AU</div> <div>© GROUND INK PTY LTD THIS DESIGN AND DRAWING IS PROTECTED BY COPYRIGHT.</div>	<div>NOTE</div> <div>VERIFY ALL DIMENSIONS ON SITE BEFORE COMMENCING WORK. REPORT ALL DISCREPANCIES TO LANDSCAPE ARCHITECT PRIOR TO CONSTRUCTION. FIGURED DIMENSIONS TO BE TAKEN IN PREFERENCE TO SCALED DRAWINGS. ALL WORK IS TO CONFORM TO RELEVANT AUSTRALIAN STANDARDS AND OTHER CODES AS APPLICABLE. LOCATION OF UNDERGROUND SERVICES TO BE PROVEN ON SITE AND PROTECTED IF NECESSARY PRIOR TO CONSTRUCTION. DIAL BEFORE YOU DIG. PLANT SPECIES AND QUANTITIES SHOWN ARE INDICATIVE ONLY AND ARE SUBJECT TO CHANGE BASED ON FUTURE PROJECT REQUIREMENTS.</div>	ISSUE	DATE	DESCRIPTION	DRAWN	REVIEW	<div>DRAWING TITLE</div> <div>LANDSCAPE DETAILS</div>	DATE	JOB NUMBER	DRAWING NUMBER
		A	29/04/24	DA ISSUE	RL/QN	RL		20-MAY-24	20240424	LA-02
		B	30/04/24	DA ISSUE	QN	RL		PROJECT		
		C	20/05/24	DA ISSUE	QN	RL		62 CHELMSFORD AVENUE		
								BELMORE, NSW 2192		
								REV		
								C		